

CompactRoller

Compact construction with two poles to ensure a perfect vertical stability

- ➔ Compact aluminum structure.
- ➔ High quality interior roll-up mechanism.
- ➔ Easy assembly with no possibility of breakage.
- ➔ Individual cardboard packing with transport bag included.



DETAILS



ASSEMBLY

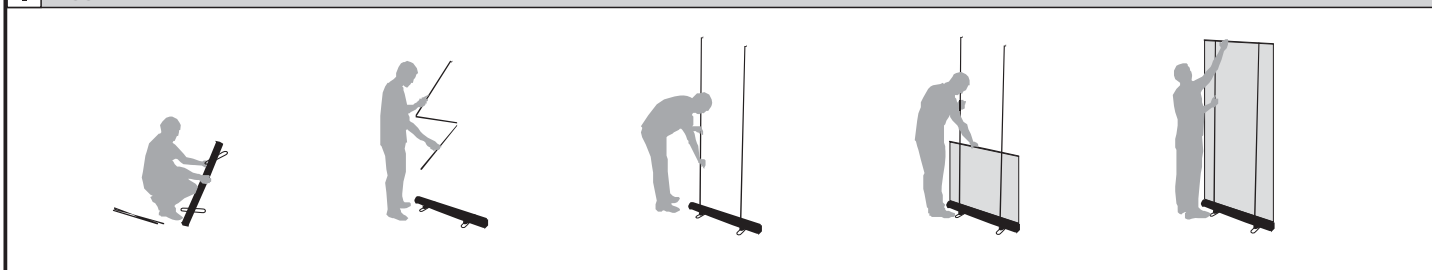

DATA



Reference	CRO-100200	CRO-120200
Size (mm)	1005x90x75	1205x90x75
Packing box	1070x145x125	1260x145x125
Weight (kg)	4,0	4,5
Material - Color	Anodized aluminum - Silver	

PACKING

